

**Mobile Base**  
**Model: 25-910 (Fits 25-010)**



Record the serial number and date of purchase  
in your manual for future reference.

Serial number: \_\_\_\_\_

Date of purchase: \_\_\_\_\_

For more information:

[www.rikontools.com](http://www.rikontools.com) or [info@rikontools.com](mailto:info@rikontools.com)

For Parts or Questions:

[techsupport@rikontools.com](mailto:techsupport@rikontools.com) or 877-884-5167









## Operator Safety: Required Reading

**IMPORTANT!** Safety is the single most important consideration in the operation of this equipment. The following instructions must be followed at all times.

There are certain applications for which this tool was designed. We strongly recommend that this tool not be modified and/or used for any other application other than that for which it was designed. If you have any questions about its application, do not use the tool until you have contacted us and we have advised you.

### General Safety Warnings

**KNOW YOUR POWER TOOL.** Read the owner's manual carefully. Learn the tool's applications, work capabilities, and its specific potential hazards.

|   |   |
|---|---|
|     | <p><b>⚠ DANGER</b> <b>ALWAYS GROUND ALL TOOLS.</b><br/>If your tool is equipped with a three-pronged plug, you must plug it into a three-hole electric receptacle. If you use an adapter to accommodate a two-pronged receptacle, you must attach the adapter plug to a known ground. Never remove the third prong of the plug.</p> <p><b>ALWAYS AVOID DANGEROUS ENVIRONMENTS.</b><br/>Never use power tools in damp or wet locations. Keep your work area well lighted and clear of clutter.</p> |
|    | <p><b>⚠ DANGER</b> <b>ALWAYS REMOVE THE ADJUSTING KEYS AND WRENCHES FROM TOOLS AFTER USE.</b><br/>Form the habit of checking to see that keys and adjusting wrenches are removed from the tool before turning it on.</p> <p><b>ALWAYS KEEP YOUR WORK AREA CLEAN.</b> Cluttered areas and benches invite accidents.</p>  |
|  | <p><b>⚠ DANGER</b> <b>ALWAYS KEEP VISITORS AWAY FROM RUNNING MACHINES.</b><br/>All visitors should be kept a safe distance from the work area.</p> <p><b>ALWAYS MAKE THE WORKSHOP CHILDPROOF.</b><br/>Childproof with padlocks, master switches, or by removing starter keys.</p>   |
|  | <p><b>⚠ DANGER</b> <b>NEVER OPERATE A TOOL WHILE UNDER THE INFLUENCE OF DRUGS, MEDICATION, OR ALCOHOL.</b></p>  |
|   | <p><b>⚠ DANGER</b> <b>ALWAYS WEAR PROPER APPAREL.</b><br/>Never wear loose clothing or jewelry that might get caught in moving parts. Rubber-soled footwear is recommended for the best footing.</p>  |
|   | <p><b>⚠ DANGER</b> <b>ALWAYS USE SAFETY GLASSES AND WEAR HEARING PROTECTION.</b><br/>Also use a face or dust mask if the cutting operation is dusty.</p>  |
|   | <p><b>⚠ DANGER</b> <b>NEVER OVERREACH.</b><br/>Keep your proper footing and balance at all times.</p>   |
|   | <p><b>⚠ DANGER</b> <b>NEVER STAND ON TOOLS.</b><br/>Serious injury could occur if the tool is tipped or if the cutting tool is accidentally contacted.</p>  |

# Assembly

## Wheel Kit Components

### Wheel Kit

3. 1 x Release pedal
4. 4 x Fixing Pins
5. 2 x Axles
6. 2 x Brace support bars
7. 7 x Nuts, bolts and washers (each)
8. 1 x Operating frame pedal
9. 1 x Operating frame
10. 2 x Castor wheels
11. 2 x Fixed wheels

**CAUTION!** To fit the legs the machine must be placed onto its side. The machine is heavy. Additional help or a suitable lifting device or support will be required for lifting the machine onto the stand.

### 3.3 Wheel Kit Assembly

1. On the underside of the operating frame, find the two raised areas on either side. Mount the two fixed wheels and secure in place using the nuts and bolts provided
2. Take the two castor wheels and mount and secure them to the operating frame pedal.
3. Feed one of the axles through the hole on the brace support bar and secure it using the pins provided.
4. Feed the axle through the fixing holes on the legs and place the operating frame pedal over the axle.
5. Repeat this process at the opposite side ensuring that both sides of the axle have been secured with the fixing pins and that both sides of the operating frame pedal are fixed.
6. With the operating frame in hand, locate the release pedal and fix it to the operating frame.
7. Return to the stand and partially fitted wheel kit and secure the operating frame to the stand.
8. Feed the second axle through the holes in the brace support bars and legs at the other side of the stand and secure it using the fixing pins.
9. At this point it is important to ensure that the operating frame sits below the operating frame pedal and that the release pedal hooks under the operating frame pedal. It is possible to adjust the operating frame to enable the release pedal to hook onto the operating frame pedal.

### Wheel Kit Operation

To operate the wheel kit press down on the operating frame pedal. This motion raises the planer thicknesser and stand. The release pedal catches onto the operating frame pedal allowing the planer thicknesser to be wheeled freely around the workshop. To set the planer thicknesser in position, press down on the release pedal. This motion releases the catch and lowers the planer thicknesser allowing the stand to make contact with the floor.

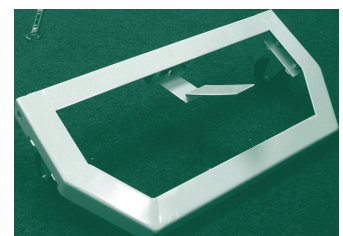
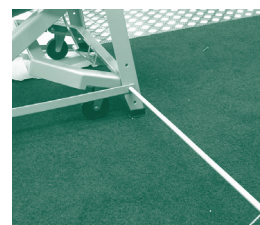
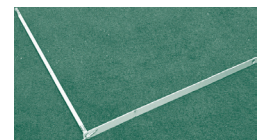
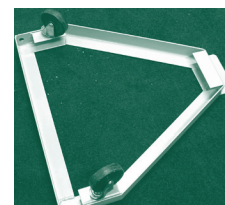
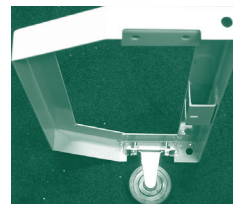
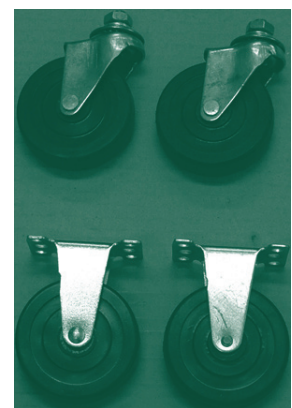
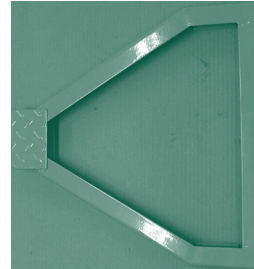



| ITEM | DESCRIPTION       | Q'ty |
|------|-------------------|------|
| 1    | Pedal             | 1    |
| 2    | Flat Washer       | 2    |
| 3    | Hex.Nut           | 2    |
| 5    | Washer            | 4    |
| 6    | Shaft             | 2    |
| 7    | Split Pin         | 4    |
| 8    | Movable Castor    | 2    |
| 9    | Hex Screw         | 5    |
| 10   | Castor            | 2    |
| 11   | Plate Spring      | 1    |
| 12   | Hex.Nut           | 5    |
| 13   | Flat Washer       | 5    |
| 14   | Movable Frame     | 1    |
| 15   | Calibrating Ruler | 2    |

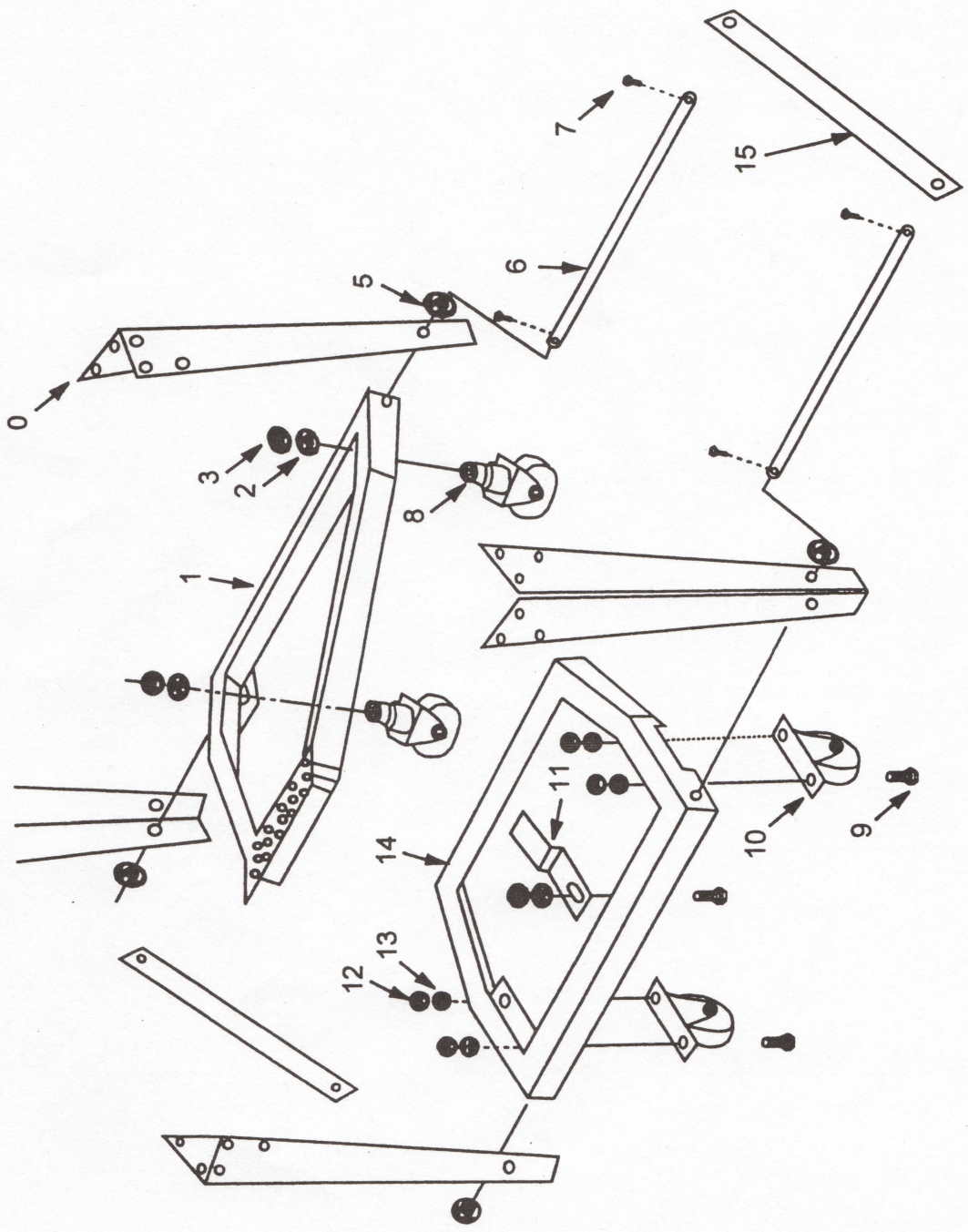

Note: The calibrating ruler can calibrate the distance of two legs of stand and assure the assembly accuracy. Removing the calibrating ruler when tighten all screws, otherwise may interfere castors.